

SPACECODE STATION



The Spacecode Station is a versatile RFID reader that can be mounted under any work surface to optimize fast processing and item tracking “Pick to light” to find items immediately.



PROCESS MANAGEMENT
RAPID AND RELIABLE



LED 'PICK TO LIGHT'
IDENTIFIES ITEMS INSTANTLY



AUTOMATED 24/7 INVENTORY
TRACK-AND-TRACE FROM ANYWHERE



The Spacecode Station RFID reader is used in healthcare facilities to efficiently count, identify, track and read small quantities of RFID tagged items, placed in a defined orientation. Mounted under any desk or work surface, it is an ideal desktop device for fast and repetitive counting processes where speed and accuracy are of the essence.

Ideal for fast-tracking labor-intensive inventory activities, it offers rapid and reliable reading of items such as blood bags, catheters, pharmaceutical packages, stents and specimens, as they are transferred through various processing steps and personnel.

Multiple items can be placed on the Spacecode Station and the LED 'pick to light' feature will indicate the specific item being sought.

KEY FEATURES

- Built in RFID antenna
- Integrates seamlessly with ERP system
- Reads tags in a defined orientation
- Rapid processing of items
- Reliable track-and-trace of stock movement
- Speedy stock count
- Easy to use and simple workflow integration
- Data can be read and reviewed using a tablet, cell phone or PC



TECHNICAL SPECIFICATIONS

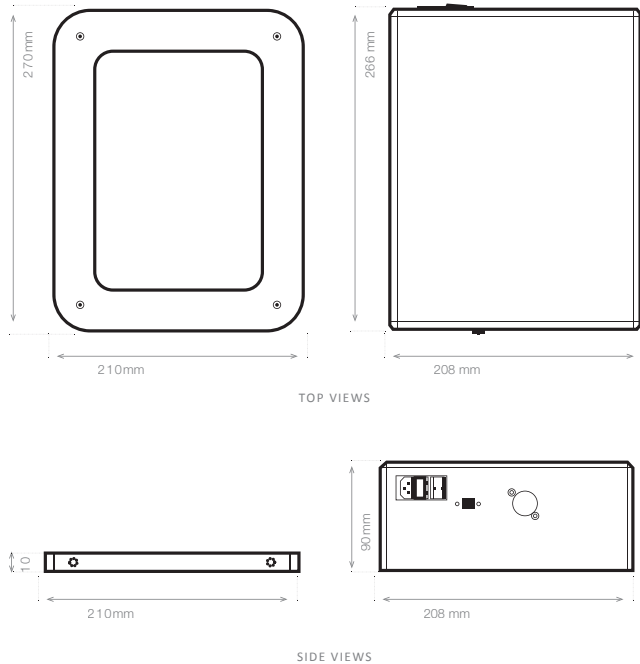

DIMENSIONS

External Dimensions	Reader Box: 268 X 208 X 100 [MM] (W X D X H) Antenna: 270 X 210 X 10 [MM] (W X D X H) Removable shelf separator- 290 X 260 X 175 [MM]
Interior Fittings / Dimensions	
Weight	3 KG

MATERIAL

Exterior / Interior Body	Aluminum - black coated
Interior	Plastic casing - white

RFID OPERATION

Carrier Frequency	125 KHZ Global Frequency Standard (119.7 KHZ)
Technology	Spacecode Passive RFID
Tag Type	100.70-DFT 100.70-LED 97.15-DFT-LED 23.1-LED
Chip Type / Memory	SPC E2 R/W/LED 126 BITS
Data Durability	10 years

COMMUNICATION

USB	Yes
-----	-----

SOFTWARE

Software Development	SDK.NET (Software Development Kit) or keyboard emulator
Business Application	SmartTracker with central or local database

POWER

Power Supply	100-230V AC, 50-60HZ - Power On switch
Power Consumption	200W MAX
Ambient Operating Temperature	10° TO 38°C (indoor use only)

CERTIFICATION

Applicable Directives	89/336/EEC Electromagnetic Directive
Standards of Conformity	EN301 489-1 V1 8.1 - ETSI EN 300 330-2 V1.5.1 - EN 50364 of 2010 FCC Part 15A Radiated Limits CE

AVAILABLE OPTIONS

Custom antenna size
